

Combi

Combi Child Car Seat WEGO LONG Series

User Manual

- For the safety of the child, please read this user manual carefully before use and use the child car seat properly.
- Store this user manual in the storage pocket on the lower back of the main body.

This product is certified according to the UN R44/04 standard.

- Universal: Weight group 0, 1, 2
- Applicable child weight: Infants weighing up to 25 kg
- This product is suitable only for vehicles equipped with 3-point seat belts approved under UN/ECE Regulation No. 16 or other equivalent standards.
- Always check Combi's "Approved Vehicle List" before using the child car seat.



DANGER	Use only backward facing mode (do not use forward facing mode) for an infant weighing less than 9 kg.
CAUTION	To avoid causing stress to the child, avoid continuous long-time usage and give the child a break from the child car seat about once every hour. Be particularly attentive to changes in the physical condition of infants with undeveloped neck muscles.

1. Before use

Thank you for purchasing this Combi child car seat. For the safety of the child, please read this user manual carefully before use and use the child car seat properly.

The child car seat is designed to reduce injury to the child in case of traffic accident, etc. However, there is no guarantee that the child car seat can completely protect the child from injury. A child using the child car seat must be accompanied by an adult.

● Labels

The descriptions in this manual use the labels DANGER, WARNING and CAUTION to indicate important items for safe and proper use of the child car seat. These are very important items that indicate the potential consequences if not followed properly, and are categorized according to the level of severity. Always make sure to follow these items.

Label	Label contents
DANGER	Improper handling will result in imminent risk of death or serious injury.
WARNING	Improper handling may result in death or serious injury.
CAUTION	Improper handling may result in injury or damage to property.
HINT	Useful hints for using the child car seat.

2. Name of parts

Check that all parts are present before use.

Package contents

- Main body
- Inner cushion (head part, seat part)
 - * The child car seat is shipped from the factory with the urethane material inserted to the inner cushion (seat part).
- EggShock pad (EggShock type only)
 - * The child car seat is shipped from the factory with the EggShock pad inserted to the inner cushion (head part).
- User manual (this manual)

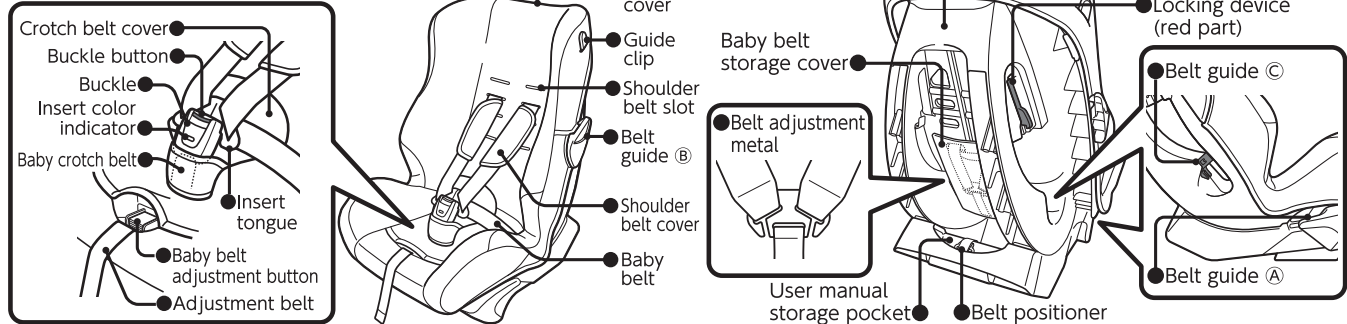

4. Types of seat belts and precautions for use

The method of installing the child car seat differs according to the type of seat belt. Installation may not be possible to some vehicles.

This product is suitable only for vehicles equipped with 3-point seat belts approved under UN/ECE Regulation No. 16 or other equivalent standards.

 DANGER	<ul style="list-style-type: none">● Always install the child car seat to a vehicle seat with a 3-point seat belt.● Never install the child car seat to a vehicle seat with a 2-point seat belt. This may prevent the child car seat from functioning properly, which is extremely dangerous to the child.		
Seat belt types and characteristics (how to distinguish)	Baby mode	Child mode	Junior mode
ELR	Can be extended and wound back when pulled slowly, but locks when pulled suddenly.	Slowly pull out the seat belt and use it to secure the child car seat.	Slowly pull out the seat belt and use it to secure the child car seat.
AELR	After the seat belt is pulled out completely, the child car seat lock function operates while winding back and the seat belt cannot be pulled out again. (The seat belt unlocks after it is completely wound back.)	It is dangerous to completely pull out the seat belt. Wind back the seat belt to release the child car seat lock function, and then install the child car seat.	It is dangerous to completely pull out the seat belt. Wind back the seat belt to release the child car seat lock function, and then install the child car seat.
Other	Seat belts other than the above.	Installation is not possible.	Installation is not possible.

* If there are questions about type of seat belt, please contact the vehicle manufacturer.

5. Inapplicable vehicle seats

Do not install the child car seat to a vehicle seat that meets any of the following conditions.

Do not use the child car seat if it cannot be secured firmly to the vehicle seat, even if none of the below conditions apply.

- Vehicle seat without a seat belt.
- Vehicle seat with a 2-point seat belt.
- Vehicle seat with a seating depth less than 40 cm.
- Deep bucket seat.
- Vehicle seat facing backwards or sideways relative to the driving direction.
- Vehicle seat with an extra large headrest.
 - * The child car seat can be installed to a vehicle seat with a removable headrest if child car seat operations can be performed after the vehicle headrest is removed.
- Vehicle seat with a passive seat belt.
 - * What is a passive seat belt?
... A seat belt that automatically fastens itself when the passenger sits in the vehicle seat and closes the door. (also called an automatic seat belt)
- Vehicle seat equipped with an airbag.
 - ... Installation is possible to a vehicle seat equipped with only a side airbag.
- Vehicle seat with the seat belt extending from the center of the seat part.
 - ... A vehicle seat with a seat belt extending from a position in front of the seat belt guide hole of the child car seat.
- Vehicle seat with an extremely uneven surface that prevents stable installation.
- Vehicle seat with a usable seat belt installation width* less than 32 cm.
 - * The width between the point where the seat belt contacts the edge of the vehicle seat and the base of the seat belt buckle.
- Vehicle seat with an extremely short seat belt.

6. For safe use of the child car seat

DANGER

- Do not seat a child who does not satisfy the use conditions, or install the child car seat to an inapplicable vehicle seat.
- When installing to the vehicle, follow the instructions in this user manual and indicated on the main body, and route the seat belt correctly through the child car seat. Do not route the seat belt incorrectly through or around the child car seat.
- Always install the child car seat properly as instructed by this user manual according to the type of vehicle seat and seat belt. If this is not possible, install to a different vehicle seat that allows proper installation.
- Always secure the child car seat with the seat belt. Do not use a rope, cord or anything other than the seat belt to secure the child car seat.

WARNING

- Do not allow the child to stand, crouch or kneel on the child car seat.
- Make sure the child is seated properly, the crotch belt cover and baby belt are fastened correctly, the left and right insert tongues are inserted firmly into the buckle, and the color indicator is green.
- Do not install the child car seat to a vehicle seat equipped with an airbag. In case of collision, the deploying airbag will strongly impact the child car seat, which is dangerous to the child.
 - ... Installation is possible to a vehicle seat equipped with only a side airbag.
- Always keep the baby belt fitting snugly. A loose belt may become wrapped around the child's neck and result in suffocation.
 - * Adjust the baby belt to the proper length.
- Store the adjustment belt properly in the adjustment belt outlet. A loose belt may become wrapped around the child's neck and result in suffocation.
- When seating a child that weighs under 7 kg, always attach the inner cushion properly to fit the child's body.
- Do not install to a vehicle seat with a damaged seat belt.
- Do not carry the child car seat with the child seated in it.

Evacuation in case of emergency

In case of accident or other emergency, an accompanying adult should press the buckle button to release the baby belt and evacuate the child from the vehicle immediately.

6. For safe use of the child car seat

WARNING

- Always use the belt positioner when using the child car seat in junior mode. Otherwise, the seat belt may deviate from the child's shoulder in the event of a collision, which is dangerous.
- When using the child car seat in junior mode with a seat belt that has a child car seat lock function, do not operate the lock function. The seat belt may squeeze the child and compress the child's chest.
- Do not install the child car seat to the passenger seat of a 2-door or 3-door vehicle when passengers will ride in the rear seat. This may obstruct exit from the vehicle in an emergency.
- Do not leave the child in the vehicle unattended.
 - On sunny days the cabin temperature may rise and pose the risk of dehydration. Other accident may also occur. An adult should always accompany the child.
- Adjust the belt positioner so that the seat belt passes over the child's shoulder.

CAUTION

- Exposing the child car seat to direct sunlight may cause the main body, insert tongue and other parts to become hot and burn the child. Park the vehicle in the shade or cover the child car seat on sunny days such as during summer time. Also, touch each part and check that it is not too hot before seating the child.
- Do not operate or adjust the child car seat while driving. Also make sure that other children riding in the vehicle do not touch or play with the child car seat.
- Do not use the child car seat as a normal chair, as it may tip over or fall, possibly resulting in injury. Do not use the child car seat for purposes or in ways other than described in this user manual.
- Make sure the child car seat does not get jammed between the vehicle doors or other movable parts.
- Users with long fingernails or artificial nails should be especially careful when fastening or adjusting the child car seat to prevent them from becoming jammed in gaps or moving parts.
- Depending on the shape and surface material (leather, etc.) of the vehicle seat, scratches or marks may remain after installation. Use of the "Combi Anti-scratch Protective Sheet" (sold separately) is recommended.
- Do not modify or improperly repair the child car seat. This may lead to accident.
- Only use parts included in the factory package or parts specifically authorized by Combi. This may damage the child car seat or result in malfunction or accident.
- Do not install with a cushion or other object between the vehicle seat and the child car seat. This will prevent the child car seat from being secured properly.
- Do not expose the child car seat to wind and rain.
- Do not use the child car seat with the seat cover and other sewn parts of the urethane and other cushioning removed. Also do not replace these parts with parts not specifically authorized by Combi for this product. (This may negatively affect safety performance in the event of a collision.)
- Be especially careful of unsecured items inside the vehicle. Sudden braking or collision may cause unsecured items to strike the child.

7. Daily inspection

To ensure proper function of the child car seat, check the following items before use.

Check that the baby belt fits snugly against the child's body. (Pull the adjustment belt to adjust the fit.)

Check that the correct baby shoulder belt slots are used and the baby belt is positioned properly.

Check that the seat belt is not loose or twisted.

Check that the seat belt insert tongue is inserted firmly into the buckle and the insert color indicator has changed to green.

Check that the child car seat is securely fastened to the vehicle seat. (Hold the sides of the main body seat and try to rock it forward and backward to make sure that it is secure.)

* The illustration shows an example of use in child mode.

8. Using the inner cushion and EggShock pad

The inner cushion is designed to offer extra protection to small infants. Use the inner cushion for a child weighing under 7 kg. (The child car seat is shipped from the factory with the inner cushion (head part) attachment strings tied through the 2nd highest shoulder belt slots.)

Attaching and removing the inner cushion

- Untie the inner cushion (head part) attachment strings that are tied on the back of the main body.
- Pull out the attachment strings from the front of the main body.
- Press the buckle button and remove the insert tongue from the buckle.
- Remove the crotch belt cover and pull the inner cushion (seat part) off of the buckle.

● Reverse the procedure to attach the inner cushion.

Using the EggShock pad

The EggShock pad can be removed from the inner cushion and inserted to the seat cover.

(The child car seat is shipped from the factory with the EggShock pad inserted to the inner cushion (head part).)

Attaching and removing the inner cushion

- Untie the inner cushion (head part) attachment strings that are tied on the back of the main body.
- Pull out the attachment strings from the front of the main body.
- Press the buckle button and remove the insert tongue from the buckle.
- Remove the crotch belt cover and pull the inner cushion (seat part) off of the buckle.

● Reverse the procedure to attach the inner cushion.

Using the EggShock pad

The EggShock pad can be removed from the inner cushion and inserted to the seat cover.

(The child car seat is shipped from the factory with the EggShock pad inserted to the inner cushion (head part).)

9. Removing and attaching the seat cover

Removing the seat cover

- Remove the baby belt storage cover from the back of the main body.
 - Unhook the left and right baby belts from the belt adjustment metal.
 - Pull out the baby belts from the shoulder belt covers.
- * The left and right shoulder belt covers are connected to each other on the back of the main body by a connecting belt.

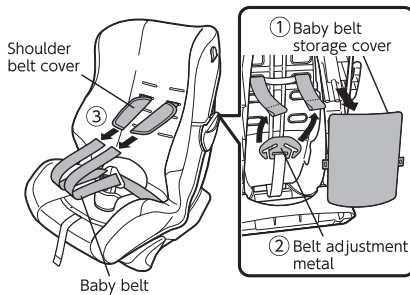

- Pull out the left and right shoulder belt covers one at a time from the back of the main body.
- Release the left and right guide clip slots on the upper part of the seat cover from the guide clips, unhook the left and right attachment loops and the hooks, and remove the seat cover.

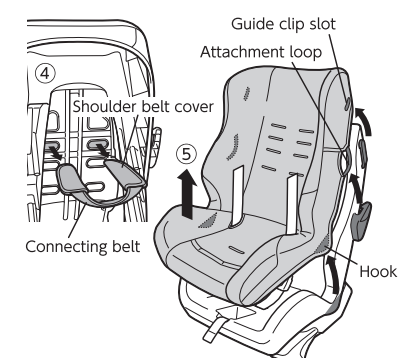

- Reverse the procedure to attach seat cover.

10. Maintenance, storage and disposal

Washing the seat cover and other sewn parts

Be sure to follow the washing instructions and cautions below.

- Follow the instructions noted on the washing label sewn onto the seat cover.
- Wash by hand with cold or lukewarm water.
- Do not use bleach.
- Use a neutral detergent.
- Do not use detergent containing fluorescent brightener or bleach. This may cause chapped skin or a rash.
- Do not iron.
- Do not dry clean.
- After washing by hand, wring out lightly.
- After wringing out lightly, arrange the shape and dry in the shade.
- Do not use a spin or tumble dryer after washing.
- Color fading may occur due to the nature of the product.

Maintenance of the main body and baby belt

Normally wipe clean with a well-wrung wet (water) cloth. When extremely dirty, remove the dirt using a solution of neutral detergent diluted with water, then wipe with a wet (water) cloth and dry in the shade.

Urethane materials

- The dyestuff used in the seat cover and other sewn parts may transfer to the urethane materials on the back of these parts. However, this is not a problem for quality or safety.
- Remove the urethane material from inside the inner cushion before washing.

Storage

Main body

When the child car seat will not be used for a long period of time, uninstall it and store in a well-ventilated place out of direct sunlight and away from children. Allow the main body to dry thoroughly before storing it.

User manual

Be sure to read and understand this user manual before use. Always keep this user manual in the storage pocket on the base of the main body.

Disposal

- When disposing of the child car seat, follow the standards of your municipality or region.
- The child car seat may suffer structural damage in the event of collision or even if it is dropped one time or falls from a high level. In this case, immediately stop using the child car seat even if no damage is visible. When disposing of the child car seat after an accident, remove the seat cover and other parts before disposal to prevent the child car seat from being reused.

WARNING

Do not use undiluted neutral detergent, gasoline, benzene or other organic solvents when cleaning. These may damage the main body and baby belt, which is dangerous to the child.

11. Preparation for installation

DANGER

- An unsecured child car seat will not function properly, which is extremely dangerous to the child. In this case install it to a different vehicle seat.
- Do not use a rope, cord or anything other than the seat belt to secure the child car seat when installing it to the vehicle.
- Do not install the child car seat to a vehicle seat equipped with an airbag. In case of collision, the deploying airbag will strongly impact the child car seat, which is dangerous to the child.
 - * Installation is possible to a vehicle seat equipped with only a side airbag.

WARNING

- Do not install to a vehicle seat with a seat belt that is damaged in any way.
- Always secure the child car seat with the seat belt even when the child is not seated.
- If backward facing installation to the passenger seat without an airbag obstructs the driver's view to the side mirror, install the child car seat to a rear vehicle seat.
- Do not install the child car seat to the passenger seat if installation interferes with proper and safe use of the gearshift and handbrake or other driving operations.
- Do not install the child car seat to the passenger seat of a 2-door or 3-door vehicle when passengers will ride in the rear seat. This may obstruct exit from the vehicle in an emergency.

Before installation

- Park the vehicle in a flat location where the doors can be fully opened.

- Slide the front seat forward and tilt the backrest to the front to create space for easier installation to the vehicle.

Vehicle seats with a sliding function

If the vehicle seat for installation has a sliding function, slide the vehicle seat forward after installation to secure the child car seat even more firmly.

Vehicle headrest

Check the shape of the vehicle seat and the vehicle headrest, and remove the vehicle headrest if possible.

Align this gray line with the line on the side of the main body.

Check that the black lines of this Angle Checker include the vertical (90° relative to the ground).

● These black lines include the vertical when the main body is viewed from the right.

● These black lines include the vertical when the main body is viewed from the left.

Baby mode

Child mode and Junior mode

Angle Checker

Use as a reference when installing the child car seat in backward facing mode.

131426070

12. Installation in baby mode (for a child weighing under 10 kg)

- 1 Position the main body so that it faces backwards relative to the driving direction.
2 Slowly pull out the seat belt making sure that it is not twisted.
3 Hold the seat belt so that the waist and shoulder belts overlap, and slide the belts from the front end of the seat through the seat belt guide hole.
4 Insert the seat belt insert tongue into the seat belt buckle until it locks with a "click" sound.
5 Route the seat belt (waist belt) through the left and right belt guides A.

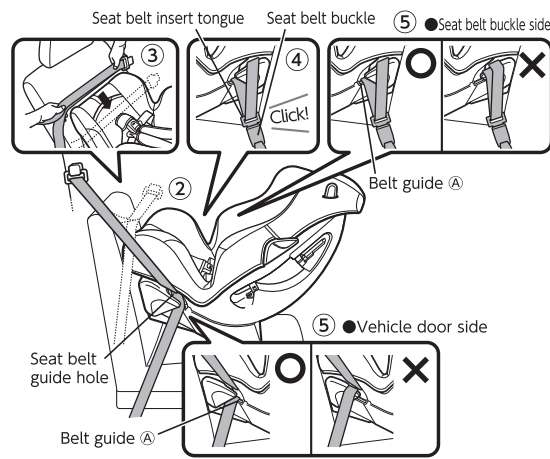

- 2 While pressing the main body against the vehicle seat, pull the seat belt (shoulder belt) to remove any looseness in the seat belt (waist belt).

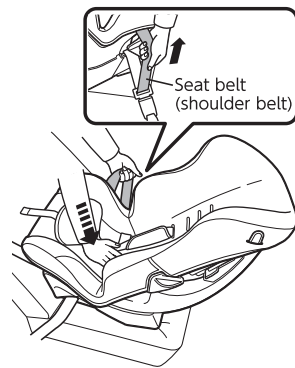

- 3 1 Route the seat belt (shoulder belt) through the belt guide A on the seat belt buckle side.
2 Press the main body against the vehicle seat (in the direction of the arrow).
3 Pull the seat belt (shoulder belt) toward the vehicle door side.

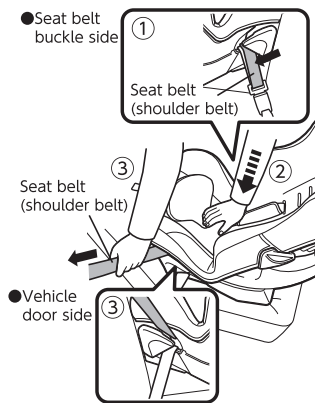

- 4 With the seat belt (shoulder belt) strongly pulled, route the seat belt (shoulder belt) under the side wall and clasp it with the belt guide B on the vehicle door side.

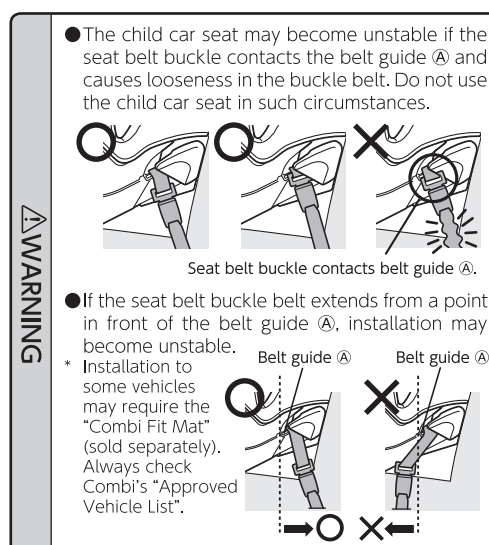
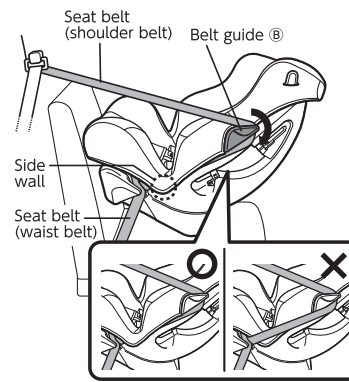

If you have any questions, please contact Combi's Customer Service Center.

- 5 Adjust the child car seat installation angle. Make sure the bottom of the main body is flat against the vehicle seat and the front end of the seat is tight against the vehicle seat backrest.

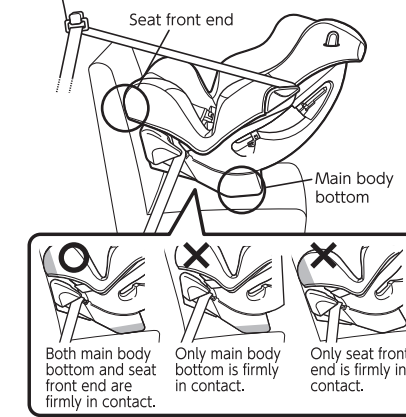

Checklist after installation in baby mode

- After installation, check the following to make sure that the child car seat is installed properly.
- 1 Check that the seat belt insert tongue is inserted securely into the seat belt buckle and does not come loose.
 - 2 Check that the inner cushion is attached for a child weighing under 7 kg.
 - 3 Check that the seat belt (waist belt) is routed through the left and right belt guides A.
 - 4 Check that the seat belt (shoulder belt) is routed through the belt guide A on the seat belt buckle side.
 - 5 Check that the seat belt (shoulder belt) is routed through the belt guide B on the vehicle door side.
 - 6 Check that the seat belt is not loose.
 - 7 Check that the bottom of the main body is flat against the vehicle seat and the front end of the seat is tight against the vehicle seat backrest.
 - 8 Hold the sides of the main body seat and try to rock the child car seat forward and back to make sure it is installed securely.
- * Due to the structure of the child car seat, the main body will move somewhat to the left and right, but this is not a problem for use.

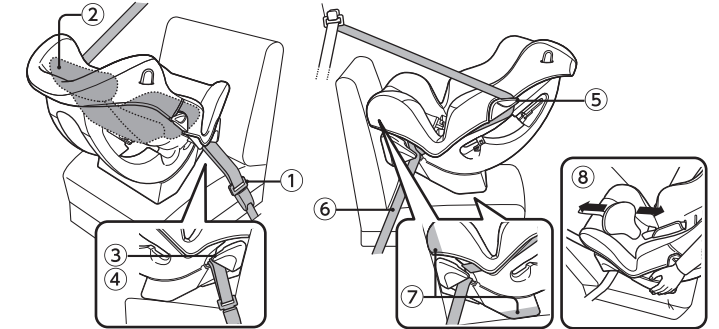

13. Installation in child mode (for a child weighing between 9 kg and 18 kg)

- 1 Position the main body so that it faces forward relative to the driving direction and is in contact with the vehicle seat backrest.

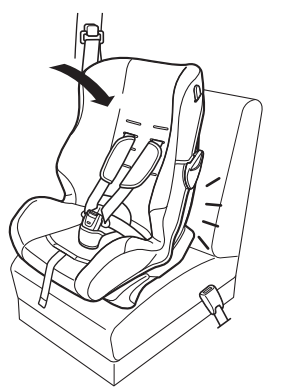

- 2 1 Slowly pull out the seat belt making sure that it is not twisted.
2 Route the seat belt through the seat belt guide hole.
3 Pull out the seat belt from the guide hole on the opposite side of the child car seat, and insert the insert tongue into the seat belt buckle until it locks with a "click" sound.

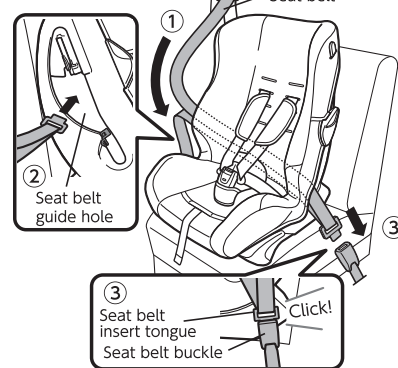

- 3 1 Route the seat belt (waist belt) through the left and right belt guides C.
2 Route the seat belt (shoulder belt) through the belt guide C on the seat belt buckle side.

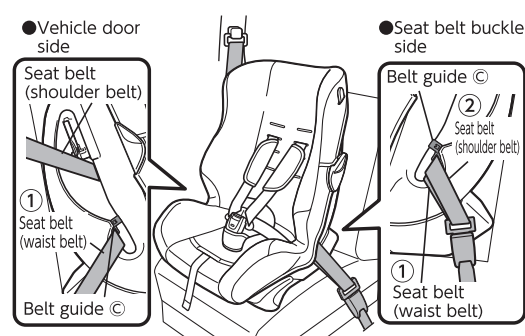

- 4 1 Place your knee deeply into the seat and apply body weight to press the main body down onto the vehicle seat.
2 Strongly pull the seat belt (shoulder belt) in the direction of the arrow (parallel to the ground) to remove any looseness in the seat belt (waist belt).

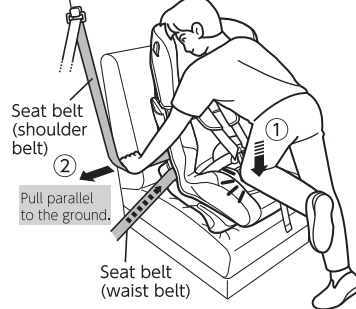

- 5 With the seat belt (shoulder belt) strongly pulled, open the red locking device on the vehicle door side.
6 Insert the seat belt (shoulder belt) to the top of the open locking device, and press the locking device to close it.

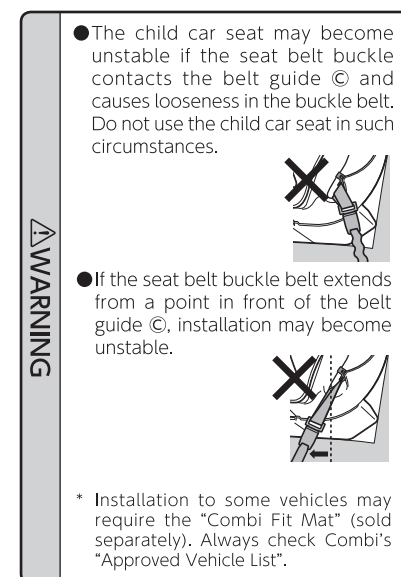
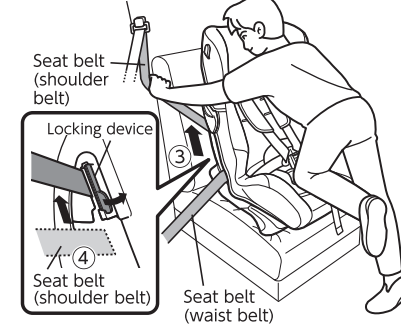

Checklist after installation in child mode

- After installation, check the following to make sure that the child car seat is installed properly.
- 1 Check that the seat belt insert tongue is inserted securely into the seat belt buckle and does not come loose.
 - 2 Check that the seat belt (waist belt) is routed through the left and right belt guides C.
 - 3 Check that the seat belt (shoulder belt) is routed through the belt guide C on the seat belt buckle side.
 - 4 Check that the seat belt (shoulder belt) is routed through the locking device on the vehicle door side.
 - 5 Check that the seat belt is not loose.
 - 6 Hold the sides of the main body seat and try to rock the child car seat forward and back to make sure it is installed securely.

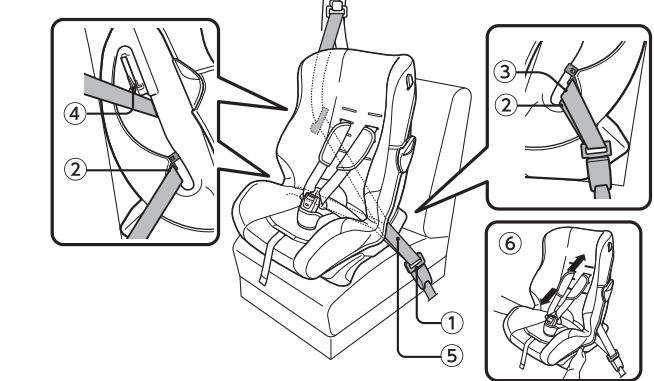

14. Adjusting the baby shoulder belt position to suit the child (baby mode and child mode)

* The baby belt is not used in junior mode.

The baby shoulder belt slot position to be selected differs in baby mode and child mode. Refer to the guide below and adjust the baby shoulder belt position before using the child car seat. * The baby crotch belt cannot be adjusted. (The child car seat is shipped from the factory with the baby shoulder belt routed through the lowermost baby shoulder belt slots.)

- Select the proper baby shoulder belt slot position according to the mode.
- Use left and right baby shoulder belt slots that are the same height.

Baby shoulder belt slot position

- Baby mode
Use the baby shoulder belt slots that are slightly below the child's shoulder height.

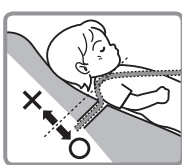

- Child mode
Use the baby shoulder belt slots that are slightly above the child's shoulder height.



- 1 1 Peel back the adjustment belt outlet, and while pressing the back side of the belt adjustment button, grasp the left and right baby belts and pull them forward and down.

- 2 1 Do not pull on the shoulder belt covers, as this will not loosen the baby belts.

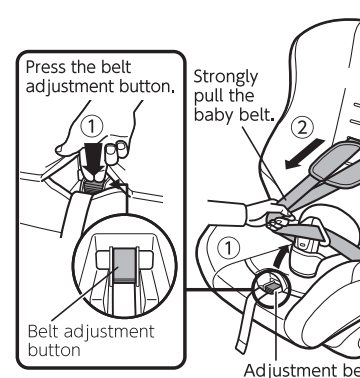

- 3 1 Remove the baby belt storage cover from the back of the main body.
2 Unhook the left and right baby belts from the belt adjustment metal.

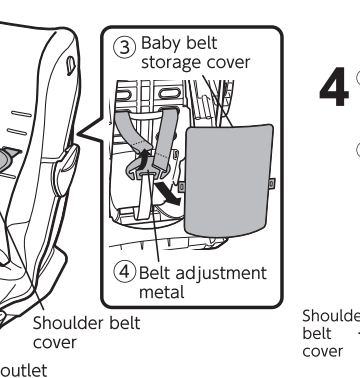

- 4 1 Pull out the baby belts from the shoulder belt covers.

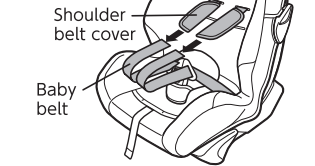

- 2 1 Pull out the left and right shoulder belt covers one at a time from the back of the main body.
2 Route the shoulder belt covers through the proper baby shoulder belt slots.

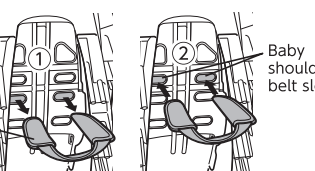

- 5 1 Route the baby belts through the shoulder belt covers, making sure they are not twisted.
2 Pull out the baby belts from the back of the main body.

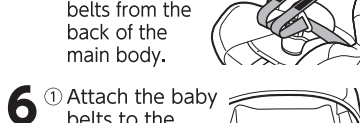

- 6 1 Attach the baby belts to the belt adjustment metal.
2 Attach the baby belt storage cover in the proper direction (top/bottom).



Make sure that the baby belt is attached properly.

15. Seating the child (baby mode and child mode)

* The baby belt is not used in junior mode.

- Do not dress the child in clothes in which the child's legs cannot be separated.
- Do not seat the child wrapped in a towel, etc.
- Do not seat the child dressed in bulky clothing or too many clothes.
- Do not seat the child incorrectly as illustrated below. The child car seat will not function properly, which is dangerous to the child.



- 1 1 Perform step 1 of "Adjusting the baby shoulder belt position to suit the child."
2 Press the buckle button and remove the insert tongue from the buckle.
3 Seat the child deeply into the child car seat and pass the child's left and right arms through the baby belt.
4 Make sure that the left and right baby belts are not twisted.

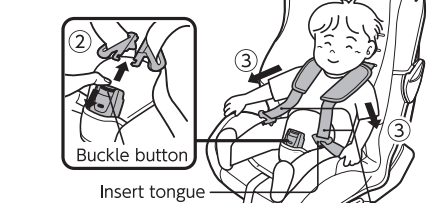

- 2 1 When using the inner cushion, seat the child deeply into the child car seat so that there is no gap with the inner cushion.

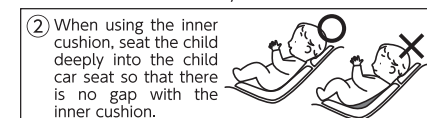

- 2 1 Match the left and right insert tongues and insert them into the buckle until they lock with a "click" sound.

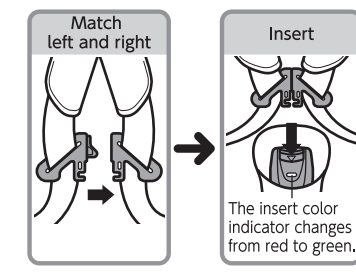

- 2 2 The buckle button is designed to be too stiff for a child to release.

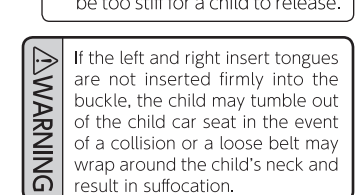

- 3 Shorten the baby belt.

- 1 Always adjust the baby waist belt so that it snugly holds the child's pelvis at the lowest position possible.
- 2 The baby shoulder belt should always be located in the center of the child's shoulder.
- 3 Pull the adjustment belt toward you, and adjust the length of the baby belt so that there is a palm's space between the child's body and the baby belt.

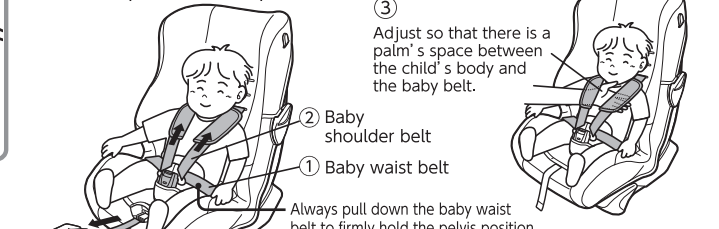

- 4 1 Always adjust the baby belt to the proper length. If the baby belt is not fit to the child's body, the child may tumble out of the child car seat in the event of a collision.
- 2 A loose baby belt may wrap around the child's neck and result in suffocation.

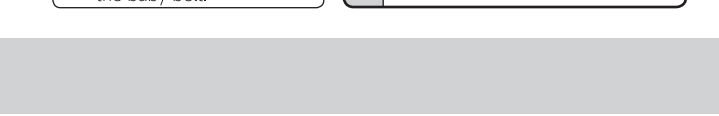

16. Preparation for junior mode

Properly store the buckle, baby belt and other parts used in baby mode or child mode.

- 1 Remove the seat cover and the shoulder belt covers. Refer to "9. Removing and attaching the seat cover" on the front side of this user manual.
- 2 1 Route the insert tongues together with the baby belts through the uppermost baby shoulder belt slots, and pull them out from the back of the main body.
2 Attach the baby belts to the belt adjustment metal. * Refer to step 6 of "14. Adjusting the baby shoulder belt position to suit the child".
3 Pull out the adjustment belt as far as possible.
4 Press down the insert tongue.
5 Attach the baby belt storage cover in the proper direction (top/bottom).

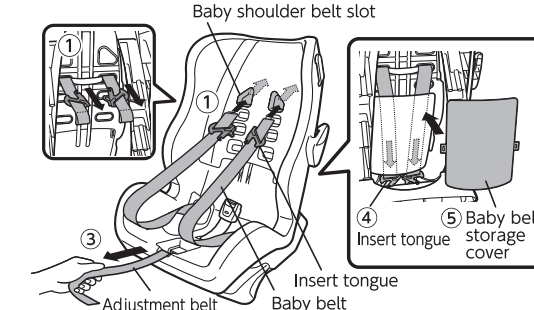

- 3 1 Roll up the pulled-out adjustment belt and store it in the storage area on the main body seat.
2 Store the buckle in the storage area together with the rolled-up adjustment belt.

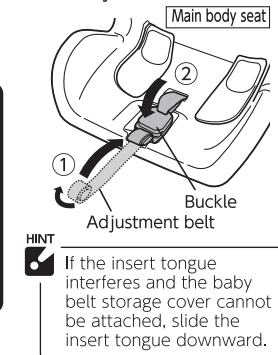

17. Installation in junior mode (for a child weighing between 15 kg and 25 kg)

- 1 Take out the belt positioner from the storage pocket.

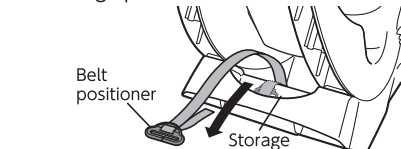

- 2 Route the belt positioner through the child car seat as illustrated, and hook it to belt guide B on the vehicle door side.

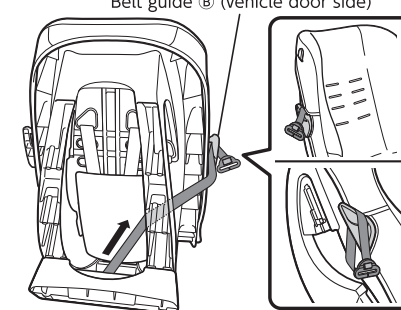

- 3 1 Position the main body so that it faces forward relative to the driving direction and is in contact with the vehicle seat backrest.
2 Pull out the seat belt.
3 Insert the seat belt insert tongue into the seat belt buckle until it locks with a "click" sound.
4 Route the seat belt (waist belt) through the left and right belt guides.
5 Route the seat belt (shoulder belt) through the belt groove on the seat belt buckle side.
6 Route the seat belt (shoulder belt) through the belt positioner.
7 Route the seat belt (shoulder belt) through the groove clip.

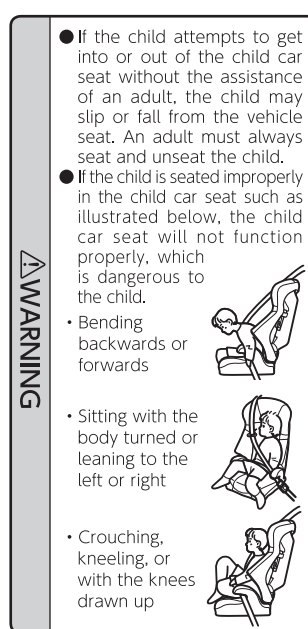
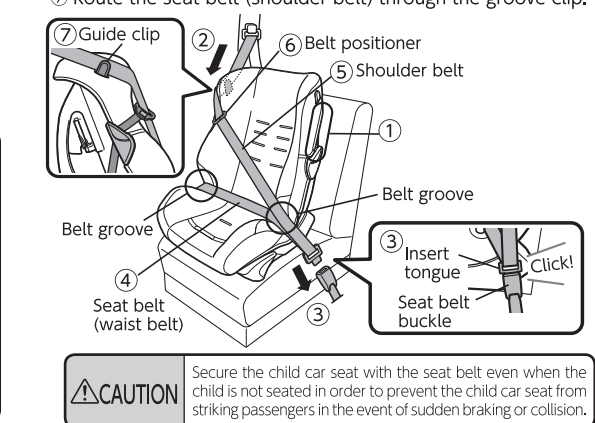

- 1 1 Release the buckle, seat the child deeply in the child car seat, pull out the seat belt, and insert the seat belt insert tongue into the seat belt buckle until it locks with a "click" sound.
2 Adjust the length of the belt positioner to suit the child.

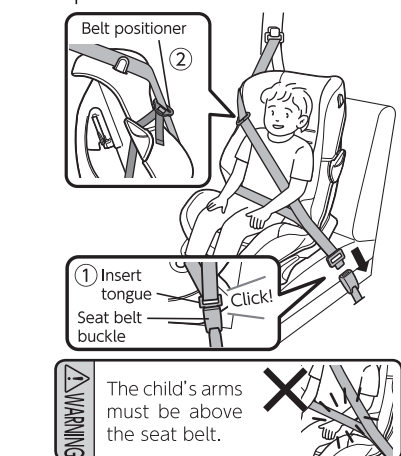

Correct position of belt positioner

Adjust the belt positioner so that the seat belt (shoulder belt) passes over the child's shoulder as illustrated on the right.



Adjusting the belt positioner

To lengthen



To shorten

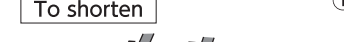

The belt positioner should be adjusted so that the seat belt (shoulder belt) holds the child's shoulder at the correct position. Adjust the height as the child grows and the belt positioner becomes too low.



The child's arms must be above the seat belt.

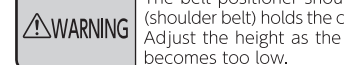

Checklist after installation in junior mode

- Check the following once the child is seated in the child car seat and the seat belt is fastened.
- 1 Check that there is not a large gap between the vehicle seat and the main body.
 - 2 Check that the seat belt (shoulder belt) is routed through the belt positioner and is not compressing the child's neck or otherwise deviating from the child's shoulder.
 - 3 Check that the seat belt fits snugly against the child's body and is not twisted or loose.
 - 4 Check that the seat belt firmly holds the child's pelvis.
 - 5 Check that the seat belt insert tongue is inserted securely into the seat belt buckle and does not come loose.
 - 6 Check that the seat belt (waist belt) is routed through the left and right belt guides.
 - 7 Check that the seat belt (shoulder belt) is routed through the belt groove on the seat belt buckle side.
 - 8 Check that the seat belt (shoulder belt) is routed through the guide clip on the vehicle door side.