

Combi LAKUMUG 使用說明書

使用前

- 使用本產品前，請詳細閱讀本說明書，並正確使用。
- 請妥善保存本說明書以供日後參考。
- 在初次使用前，請務必分解後清洗各部件，並進行消毒除菌。

目錄

- 安全使用本產品..... 1~4
- Lakumug 系列，特徵，部件名稱，單獨銷售部件..... 5~6
- 通用配件，清洗及保存..... 7~8
- 初學吸管..... 9~10
- 初學水杯..... 11~12
- 防漏吸管..... 13
- 當飲品從吸管的末端流出時..... 14

● 初學吸管只在限定國家及地區銷售。

● **互換性**
不能與「Combi mug」和「teteo mug」互換使用。
詳情請諮詢銷售商或我消費者服務中心。

安全使用本產品

● 這裡所提及的是為了確保使用者能正確而安全地使用本產品，以免閣下和幼兒受到傷害或本產品的元件受損而詳列之事項。為了分辨危險的程度，我們把操作錯誤而引起的結果區分為警告和注意事項。

警告

如操作錯誤，可能引致死亡或重大傷害。

注意

如操作錯誤，可能令人受傷，或引致元件之損壞。

使用時的注意事項

警告

● 請用於盛放溫度在 5°C~40°C 範圍內的飲品。否則可能會因漏出或溢出而導致燙傷。

● 當杯中盛有熱水等高溫液體時，請絕對不要蓋上杯蓋。否則可能會因漏出或溢出而導致燙傷。另外，杯身也會變熱，使用時請注意。切勿讓兒童觸摸。

● 如果飲料溫度過高時，請勿把水杯給幼兒。高溫的飲料也許會漏出而導致燙傷。

● 請注意，不要在空氣悶閉的狀態下裝入熱飲，也不要讓杯子受到劇烈振動或衝擊。否則可能會因杯內的空氣膨脹引起內壓升高，使得飲品從杯嘴溢出，導致燙傷。

注意

● 請務必使用 Lakumug 系列的單獨銷售部件。

● 使用中，如果用力按壓吸管部分或是通氣部分的外側，可能會導致吸管部分或是通氣部分凹陷，所以請注意不要按壓。

● 請勿跌落或撞擊杯子，否則會對產品造成損壞。

● 請勿把產品放置於接近火源的地方。

● 請勿長時間放在諸如夏季的車內等高溫場所。否則會導致變形或破損、飲品漏出、漏水。

● 請勿放在冰箱內使用。否則會導致變形或破損。

● 如發現產品有裂痕，損壞，變形或配件遺失，請立即停止使用。

● 請勿用於盛放碳酸飲料。否則可能會導致飲品漏出。

● 使用初學吸管或防漏吸管時，如果猛地打開蓋子，可能會導致飲品從吸管部分的末端流出。請由成人慢慢打開蓋子。

關於杯嘴、內吸管等矽膠部件的注意事項

● 產品表面用了白色的保護粉末，是對人體無害的食品添加物。

● 根據不同飲料特性會有味道殘留及色移的狀況，只要徹底清潔就不會有衛生上的問題。

● 矽膠配件是消耗品。如發現任何表面破損時，立刻停止使用並替換新的配件。

● 如果使用時間過久，可能會喪失彈性、易於破損，導致飲品漏出等。建議儘早更換。

於微波爐加熱的注意事項

● 微波爐加熱時要格外小心。在食用前，一定要攪拌加熱過的食物，以確保熱量均勻分佈並檢查溫度。

● **塑膠部件可能會變形、熔化或燒焦。**
請注意以下指引。

夜光把手

部品名	材質	耐熱溫度	耐冷溫度
● 通用配件			
把手 杯身 (標準杯、大杯)	聚丙烯	140°C	-30°C
● 初學吸管杯			
蓋子	聚丙烯、熱塑性彈性體	140°C	-30°C
接合器	聚丙烯	140°C	-30°C
杯嘴	矽膠	140°C	-30°C
● 初學水杯			
蓋子	聚丙烯、熱塑性彈性體	140°C	-30°C
接合器	聚丙烯	140°C	-30°C
杯嘴	矽膠	140°C	-30°C
● 防漏吸管杯			
蓋子	聚丙烯、熱塑性彈性體	140°C	-30°C
接合器	聚丙烯	140°C	-30°C
杯嘴	矽膠	140°C	-30°C
內吸管	矽膠	140°C	-30°C

有關如何安裝把手的詳細方式，請參閱(第7頁)通用配件說明。

● 產品規格可能因產品改良而發生變更，恕不另行通知。
※Lakumug 系列的包裝盒上所使用的照片，可能與產品略有差異。

警告

● 利用微波爐加熱飲品時，請將溫度控制在與人體體溫相當。

● 使用微波爐過度加熱時，飲品可能因突然沸騰(※)而突然滾沸湧出。請把加熱後的杯子放在微波爐一分鐘後再取出。從爐中取出給與孩子時，請小心溫度，不要燙傷。

※ 突然沸騰：指過熱的液體分子因受到振動而突然沸騰的現象。

● 請勿加熱密封的水杯。否則，杯子有可能會破裂，高溫飲品也有可能會突然噴出造成以外。

● 根據兒童牙齒的生長狀態，如果用力咬或是一直咬住不放，可能會導致吸嘴出現裂紋或碎裂而誤吞。塑膠部件裂開也有可能造成受傷，所以使用前請務必確認是否有異常。

● 請勿將杯子放入口中或拿著杯子四處走動。有可能跌倒造成受傷。

● 請避免孩童將舌頭深入直飲杯的縫隙中，有可能受傷。

● 為閣下的幼兒安全和健康起見，必須在成人監督下使用此產品。

● 連續和長時間吮吸吸嘴會導致蛀牙。

● 在幼兒飲用前必須檢查溫度。

● 請將所有不被使用之部品放置於幼兒觸及不到的地方。

注意

● 請勿將Lakumug 水杯用作幼兒喝水以外的用途。

● 請勿在將各部件拆開的狀態下交給兒童。否則可能會出現小部件被誤吞、突起部位戳到咽喉或眼睛、縫線夾到手指等情況。

● 請如本書的描述，正確安裝各部件，並將接合器牢固安裝到指定位置。如果未能正確安裝，可能會導致杯內的飲品漏出。

注意

● 不可在烤箱、烤架、烤麵包機、蒸籠功能上使用。

對於自動切換功能型，請充分予以注意。

- 加熱前請先確認微波爐腔內的溫度是否已冷卻。
- 請勿加熱空的杯子。
- 只可加熱杯身。加熱前請將其零件取下。

● 油、糖分過高的飲品在加熱時溫度可能會變得非常高，所以請勿用於加熱此類飲品。

● 加熱飲品時，請勿使用自動烹飪功能，請務必縮短加熱時間，一邊查看狀態一邊加熱勿超過40°C。

● 可能會因使用微波爐加熱而導致杯內的飲品漏出。盛放飲品時，請勿超過標註為 MAX 的刻度線。

外出攜帶時的注意事項

Lakumug 附有防漏設計。但依存放狀態不同，仍有可能滲漏。

攜帶移動時，若擔心沾濕包包內內容物，為了保險起見，請裝入可密封的袋子中。

- 杯子被橫放或顛倒，可能會發生滲漏。
- 放入包中攜帶時，請注意不要讓杯蓋在包內打開。
- 當盛放高於人體溫度的飲品時，杯內壓力會升高，可能會導致飲品漏出。請待飲品冷卻後再裝入。
- 當裝入冷藏過的飲品攜帶時，可能會因內外溫差而導致杯內壓力升高造成滲漏。
- 盛裝冷飲時，有可能因溫差造成表面凝露產生水滴。
- 請勿把已沖調好的奶粉用水杯盛裝外帶，否則奶液可能會變質。

通用配件

安裝把手

● 將杯身前方凸出的部分跟把手圈上槽子對上。

注意

- 把手並未固定在杯身上。當接合器已拆下時，請勿抓著把手將杯身拿起。否則可能會導致杯身脫落、飲品灑出，如果是熱飲可能會導致燙傷。
- 如果把手沒有正確安裝到杯身上，接合器無法固定牢靠，可能會導致飲品漏出。

刻度

杯身上的刻度只供參考，可能跟實際容量有少許差別。

● 最大容量
標準杯.....200ml
大杯.....300ml

關於內吸管

Lakumug 系列共有 2 種內吸管。如果沒有正確安裝，可能會導致無法完全喝完杯內飲品。請按照下圖確認內吸管的長度，安裝適當長度的內吸管。

在標準杯身(200ml)上使用防漏吸管時 75mm

在標準杯身(200ml)上使用初學吸管時 97mm

在大杯身(300ml)上使用防漏吸管時

※在標準杯身(200)上使用吸管杯杯嘴時，請將內吸管剪成75mm使用。

初學吸管杯

● 採用有突起部位的結構設計，稍稍打開蓋子即會產生吮吸的感覺。在使用時，請慢慢打開蓋子。關閉時，請將蓋子一直按下，直到發出「啾啾」聲鎖住。

組裝方法

①如圖所示，將吸管部分與通氣部分從接合器內側按入安裝好。

拆卸方法

請將吸管部分與通氣部分從外側按入拆下。

● 當飲品從吸管的末端流出時，請參閱第 14 頁。

● 在打開蓋子的狀態下，請勿翻倒或搖動。飲品可能會從吸管部分的端部和通氣部分漏出來。

注意

● 當飲品從吸管的末端流出時，請參閱第 14 頁。

● 在打開蓋子的狀態下，請勿翻倒或搖動。飲品可能會從吸管部分的端部和通氣部分漏出來。

初學水杯

● 在使用時，請慢慢打開蓋子。關閉時，請將蓋子一直按下，直到發出「啾啾」聲鎖住。

組裝方法

①安裝杯嘴時，請如圖所示，從接合器內側將杯嘴的口部插入接合器，用雙手將杯嘴整個推入至接合器外側。插入時，請將口部的中央對準接合器的突起部位。

※推出杯嘴時，請注意不要按壓杯嘴的狹縫部位。

拆卸方法

如圖所示，將杯嘴口部左右向內按入，將其拆下。

※拆卸杯嘴時，請注意不要按壓杯嘴的狹縫部位。

①將把手安裝到杯身上。

②請關上蓋子，將接合器安裝到杯身上。請扭緊，直到突出部與把手的突起部位對準。

防漏吸管杯

● 採用有突起部位的結構設計，稍稍打開蓋子即會產生吮吸的感覺。在使用時，請慢慢打開蓋子。關閉時，請將蓋子一直按下，直到發出「啾啾」聲鎖住。

組裝方法

①如圖所示，將吸管部分與通氣部分從接合器內側按入安裝好。

拆卸方法

如圖所示，將吸管部分與通氣部分從外側按入拆下。

蓋子的關閉方法

關閉蓋子時，請勿觸碰防漏吸管的杯嘴，而應直接關閉。

注意

● 當飲品從吸管的末端流出時，請參閱第 14 頁。

清洗及保存

注意

● 使用後請立即清洗乾淨。如果長時間放置，可能會導致菌類繁殖，或是飲品的顏色或氣味附着。

● 如果污漬經清洗或漂白仍殘留於配件上的話，建議更換新的配件。

● 去牙垢時，請使用餐具用中性洗劑與軟毛刷。如果用硬毛刷或含有研磨劑的洗劑等刷洗，可能會導致杯子損傷或變成不透明。

● 如果過度使用漂白劑、消毒水、煮沸消毒或微波爐消毒會對產品造成損傷。

● 用較熱水或小鍋煮沸，可能會讓產品與鎖體緊密結合，進而導致變形。

清洗方法

● 使用後請立即將各部件拆卸，浸泡在溫水中，用餐具用中性洗劑仔細清洗並徹底刷乾。

● 請用餐具用中性洗劑仔細清洗初學水杯、防漏吸管的吸嘴及內吸管，並用水流沖洗乾淨。

● 當空氣圈上有污垢附著時，請用牙膏等輕輕刷乾淨。

● 如蓋子有污垢時，請在強力的自來水之下清洗。

● 使用洗碗機/烘乾機時，熱風出口會變為高溫，所以請避開熱風出口。

● 使用洗碗機/烘乾機時，請使用餐具用中性洗劑。

● 詳情請遵照洗碗機用洗劑的使用說明書。

● 使用洗碗機/烘乾機時，請將各配件拆解，並遵照洗碗機、烘乾機的使用說明書使用。

消毒除菌方法

● 煮沸消毒
請使用大鍋並裝滿充足的水，煮沸2-3分鐘。
※請煮沸超過3分鐘。

● 消毒劑消毒
請使用餐具用消毒劑。請遵照各消毒劑的使用說明書。

● 微波爐消毒
根據消毒劑成分，根據消毒劑成分泛白或色系的印刷顏色變淡等加速老化的狀態，建議不要超過1小時。

● 請使用餐具用消毒劑。接合器、奶嘴等配件請勿混合消毒。詳情請遵照各器具的使用說明書。

保存

● 請將水杯存放於幼兒觸及不到的地方。否則，幼兒可能在意想不到的情況下吞下配件。

能夠吸飲水前

初次不習慣使用的幼兒作為目標請放入150ml以上的容量的飲品。飲用的時候，從吸管頂端飲用飲品會更容易。

開始訓練

① 含住吸管部分.....適量水分流出

② 收縮嘴脣.....吮吸水分

當兒童含入後，吸管根部受到按壓，就會有適量的水分從吸管的末端流出。開始訓練時，請由成人將吸管的末端放入兒童口中，觀察狀況。

※均為估計值，請不斷重複直到能夠做到。也有並非按照①→②順序的情況。監護人無需急於，請一邊感受兒童的成長，一邊共同感受快樂吧。

在吸管的末端收縮嘴脣、吸入，即可吸出少量水分。當能夠使用「初學吸管杯」熟練吸水後，請使用「防漏吸管杯」。吸管的末端膨大，形成易於含住、易於飲水的形狀。

注意

● 請依圖(A)所示，將吸嘴正確放在嘴脣間使用。

● 使用時，如果兒童將手指伸入初學水杯杯嘴的狹縫中，可能會導致狹縫變寬或是杯嘴破裂，進而引起漏水。

● 如果食物等異物卡入初學水杯杯嘴的狹縫中，可能會因狹縫始終保持打開狀態而漏水。

● 杯嘴為消耗品。長期使用同一個杯嘴，可能會因失去彈性、狹縫擴張、破裂而導致漏水。

● 如果在蓋子打開的狀態下橫放，可能會導致飲品漏出。

傾斜角度(傾斜角度的目標值)

成人應一邊確認傾角，一邊對準兒童的嘴部。

傾斜檢查視窗

傾斜至飲品達到線的位置。

當飲品從吸管的末端流出時

如果在蓋子打開的狀態下放置初學水杯與防漏吸管，可能會因杯子內外的溫差而產生壓力差，進而導致飲品從吸管流出。

這種情況下，如圖B所示，將通氣部分排在接合器凸起的部位，可讓空氣打開釋放壓力，防止飲品從吸管流出。

※在圖B狀態下倒著攜帶杯子，會導致飲品流出。在交給兒童前，請務必將通氣部位恢復為正常狀態。(圖A) ※如右側插圖(圖C)所示，用手指按壓通氣孔部分令其變形，臨時釋放壓力。

蓋子打開時，通氣部分會稍稍打開以釋放杯內壓力，因此若將杯子放倒或搖晃，飲品可能會從通氣部分漏出。雖然隨著時間的經過也會自行關閉，但如果用手指捏住通風部分，會關閉的更快。

注意

● 請不要在蓋子打開的狀態下隨意放置、放倒或搖晃。飲品有可能從吸管的前端或通氣部分漏出。

● 空氣圈打開的時候，飲品有可能會噴出，請注意。● 放置時請將蓋子關閉。

Lakumug 系列

4個月+ 初學吸管杯

5個月+ 初學水杯

6個月+ 防漏吸管杯

● 為了確保兒童能夠順利的從乳頭過渡到吸管，在杯嘴設計上，採用了加粗根部形狀以便如同乳頭般易於含入，與吸管末端形狀相組合。

● 當兒童含入後，吸管根部受到按壓，就會有適量的水分從吸管部分的末端流出，隨著兒童的動作，即可完成利用嘴脣「含入、收縮、吮吸」的吸管飲水訓練。

● 所標註的月齡是表示訓練的開始時間。實際開始使用時間，請根據兒童發育狀況綜合判斷。另外，在兒童能夠自行飲用之前，成人應予以幫助。

初學吸管杯 4個月+

吸管型

Lakumug 初學吸管杯，是能夠完成吸管飲水訓練的杯子。

● 為了確保兒童能夠順利的從乳頭過渡到吸管，在杯嘴設計上，採用了加粗根部形狀以便如同乳頭般易於含入，與吸管末端形狀相組合。

● 當兒童含入後，吸管根部受到按壓，就會有適量的水分從吸管部分的末端流出，隨著兒童的動作，即可完成利用嘴脣「含入、收縮、吮吸」的吸管飲水訓練。

單獨銷售部件

- 蓋子接合器
- 杯嘴
- 內吸管

初學水杯 5個月+

杯子型

Lakumug 初學水杯，是能夠完成水杯飲水訓練的杯子。

● 只有含住杯嘴時狹縫才會打開，讓水流出，所以可以放心進行水杯飲水練習，無須擔心撒漏。

● 用初學水杯飲水時，由於無法掌握傾斜角度，所以成人應予以幫助。為了確保兒童容易提供幫助，採用了易於查看傾角的傾斜檢查視窗。

※關於傾斜角度的目標值，請參閱「初學水杯」(11~12頁)。

單獨銷售部件

- 蓋子接合器
- 杯嘴

防漏吸管杯 6個月+

吸管型

Lakumug 防漏吸管杯，是為了能夠進行吸管飲水而使用的杯子。

● 採用獨特的閘門構造，不易漏水，打開蓋子狀態下放置時，也可通過自動空氣閘門防止吸管部分漏水。

● 杯嘴採用易於含入的末端形狀。

● 杯嘴採用軟性材質，可保護兒童口腔。(請注意，用牙用力咬咬可能會導致破損)

※「防漏」不包含錯誤使用、經年老化的情況。

單獨銷售部件

- 蓋子接合器
- 杯嘴
- 內吸管

Combi LAKUMUG

Instruction manual

- Before use**
- Please read this manual carefully and use accordingly.
 - Please keep this manual for future reference.
 - Disassemble and wash all parts and sterilize before first use.

Index

For safe use of the product. Cautions when using 1 ~ 4

Lakumug series. Features. Name of the parts. Parts sold separately 5 ~ 6

Common parts. Care and storage 7 ~ 8

First straw 9 ~ 10

First cup 11 ~ 12

Straw 13

When drink flows out from the tip of the straw 14

● The First Straw is only available in specific countries and regions.

● **About compatibility**
Incompatible with 「Combi mug」 and 「Teletto mug」.
For more information, contact the dealer or our customer service center.

For safe use of the product

- The caution items listed advise how to use the product correctly and safely so as to prevent any possible injury to the user and/or baby and prevent any damage to the product.

WARNING
Improper use may directly cause death or injury.

CAUTION
Improper operation may cause injury to user or damage the product.

Cautions when using

- WARNING**
- Fill the cup with drink in temperature from 5°C to 40°C. Otherwise, scald may occur due to leakage or overflow.
 - When there is hot liquid such as hot water in the cup, never cover the cup with cap. Otherwise, scald may occur due to leakage or overflow. In addition, the cup body may become hot. Be careful when using. Keep the cup out of the reach of children.
 - Do not give the mug to the baby when the liquid temperature is high. The hot liquid may leak out and injure the baby.
 - Do not fill hot drink in the cup with air valve closed or let the cup subject to violent vibration or impact. Otherwise, drink may overflow from the cup mouth due to rise of internal pressure caused by air expansion in the cup, thus causing scald.

Light Storage LakuMug

Light storage products can store the energy of sunlight and lamplight. The light storage part (handle) can emit light for several hours. The brightness, time and visibility will be vary due to the surrounding brightness and other environmental factors. For the installation method of the handle, please refer to common parts (page 7).

Part	Material	Heat resistance	Cold resistance
● Common parts			
Handle	Polypropylene	140°C	-30°C
Cup (Standard · Large)	Polypropylene	110°C	-30°C
● First straw			
Cap	Polypropylene · TPE	140°C	-30°C
Adapter	Polypropylene	140°C	-30°C
Drinking spout	Silicon	140°C	-30°C
Inner straw	Silicon	140°C	-30°C
● First cup			
Cap	Polypropylene · TPE	140°C	-30°C
Adapter	Polypropylene	140°C	-30°C
Drinking spout	Silicon	140°C	-30°C
● Straw			
Cap	Polypropylene · TPE	140°C	-30°C
Adapter	Polypropylene	140°C	-30°C
Drinking spout	Silicon	140°C	-30°C
Inner straw	Silicon	140°C	-30°C

Standard cup: Volume: 200ml
Large cup: Volume: 300ml

※ The product specifications are subject to change without notice.
※ Photos on the package of the Lakumug series may differ slightly from the actual product.

23.03

WARNING

- When microwave heating, keep drink at the temperature same as human body.
- When microwave heating, drink may erupt due to superheating effect (※). Leave the heated cup for 1 minute before taking it out. Please be careful not to get scald when taking it out of the oven and giving it to your child.
※ Superheating: The effect of being overheated due to sudden boiling caused by violent impact.
- Do not microwave heat a sealed mug as the mug may break and hot drink may puff out causing injury.
- Depending on the growth status of children's teeth, if they bite hard or keep biting, the spout may crack or break and be swallowed by mistake. Cracked plastic parts may also cause injury, so be sure to check for abnormalities before use.
- Please avoid children penetrating their tongues into the slit of the spout, it may cause injury.
- For your child's safety and health
- Always use this product with adult supervision.
- Continuous and prolonged sucking of fluids will cause tooth decay.
- Always check food temperature before feeding.
- Keep all components not in use out of the reach of children.

- CAUTION**
- Do not use the Lakumug for any purpose other than a mug.
 - Do not give the mug to children with parts disassembled. Otherwise, small parts may be swallowed. Protruding parts may hurt the throat or eyes, and fingers may be pinched in gaps.
 - Correctly install the parts and firmly attach the adapter in the specified position according to this manual. Incorrect installation may cause leakage.

CAUTION

- Do not use the product under the oven, grill, toaster and steamer functions. Pay attention to the types with automatic switching functions.
 - Before heating, make sure that the chamber of the microwave oven cools down.
 - Do not heat an empty cup.
 - Only heat the cup. Remove all other parts.
 - Do not heat the drink that contains a lot of oil and sugar as the temperature may become very high during heating.
 - When heating drink, do not use the automatic cooking function. Be sure to shorten the heating time and check the status during heating and heating temperature is under 40°C.
 - Drink may overflow due to microwave heating. Therefore, do not fill the drink beyond the MAX line.
- Cautions during outing**
Lakumug is leak-proof design, but the drink inside may still leak out depending on the storage conditions or position. If you are worried about getting your bag wet when carrying it out, please put it in a sealed bag just in case.
- Leakage may occur when the cup is placed horizontally or upside down.
 - Please don't keep the cap open when carry the cup with a bag.
 - When the cup contains drink with the temperature higher than human body temperature, pressure in the cup will rise, which may cause leakage. Fill in the cup after the drink cools down.
 - When the drink cooled in a refrigerator is filled in the cup, the drink may leak due to rise of pressure in the cup caused by temperature difference inside and outside the cup.
 - When the cup contains cold drink, condensation occurs on the surface of the cup, thus producing water drops.
 - Never use the mug to carry formula milk when outing, otherwise the milk may go bad.

Common parts

- Attaching the handle**
- Match the protruded parts on the front of the cup with the slots on the handle's ring top.

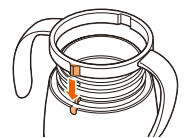

CAUTION

- The handle is not fixed on the body of the cup. When the adapter is removed, do not pick up the cup by holding the handle. Otherwise, the cup may fall off and drink may spill. If it is hot drink, scald may be caused.
- If the handle is not correctly installed on the body of the cup, the adapter cannot be firmly fixed. As a result, drink may leak.

The scale indicated on the cup is for reference only and may be slightly different from actual volume.

- **Maximum volume**
Standard cup...200ml
Large cup...300ml

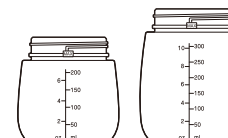

About inner straw

Lakumug series has two types of inner straw. If the straw is not correctly installed, drink in the cup may not be drunk off. As shown in the following figure, check the length of the inner straw and install the inner straw of appropriate length.

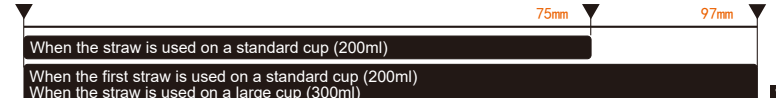

First straw

- The cup adopts a structure with convex part the cap is opened a little, you will hear a click sound. When you use the product, slowly open the cap. To close the cap, press it downward until a click sound is heard, which means the cap is locked.

How to assemble

- As shown in the figure, install the straw and air vent by pushing them from inside of the adapter.
- As shown in the figure, insert the inner straw all the way until it reaches the line.
- After the inner straw is inserted, gently pull the straw to ensure that it cannot be pulled out.
- Install the handle on the cup.
- Close the cap and install the adapter on the cup. Screw up until the protruding part match with the protruding part of the handle.

How to disassemble

- Remove the straw and air vent by pushing it down from outside.

CAUTION

- When drink flows out from the tip of the straw, see page 14.
- Do not overturn or shake the cup with the cap open. The drink may leak out from the tip of the straw or the air vent.

First cup

- When you use the product, slowly open the cap. To close the cap, press it downward until a click sound is heard which means the cap is locked.

How to assemble

- As shown in the figure, install the drinking spout. Insert the spout part into the adapter from the inner side and push it to outer side with both hand. When insert, align the central part of the spout part with the protruding part of the adapter.
- When you push out the drinking spout, do not press the slit.
- Install the handle on the cup.
- Close the cap and install the adapter on the cup. Screw up until the protruding part match with the protruding part of the handle.

How to disassemble

- As shown in the figure, press the spout part of the drinking spout inward from the left and right to remove it.
- When you remove the drinking spout, be careful not to press the slit.

Care and storage

CAUTION

- Wash the cup immediately after using. If the cup is left unused for a long time, it may cause bacteria reproduction or odor or color residue.
- It is recommended to replace with new ones if stains remain on the parts after cleaning or bleaching.
- Please use neutral detergent for tableware and soft sponge when washing. If scrub with a hard bristle brush or any detergent with abrasive, it may damage the cup or opacity the cup.
- Overuse of bleach, disinfectant, boiling disinfection, or microwave disinfection can cause damage to the product.
- If you boil the cup using little hot water or a small pot, the product may closely contact with the pot, thus causing deformation.

Washing method

- Disassemble the mug immediately after using, soak in warm water, wash carefully with neutral detergent for dishes and dry thoroughly.
- Carefully wash the drinking spout of the first straw and straw and the inner straw with detergent for dishes, and rinse off with water. Do not put your finger in it or pull it to open.
- If the air valve gets dirty, clean it gently with a toothpick.
- Rinse the cap with strong running water if there is dirt on the inner side.
- When using a dishwasher or dryer, keep the product away from the hot air outlet because it will become hot.
- When using a dishwasher or dryer, use the relevant neutral detergent. For details, follow instructions on the detergent for dishwashers.
- Do not use commercial dishwasher or detergent for commercial dishwashers.
- When using a dishwasher or dryer, please disassemble each part and follow the instruction manual of dishwasher or dryer to use.

Disinfection and sterilization method

- Sterilize in boiling water**
When sterilizing in boiling water, use a large saucepan filled with plenty of water boil for 2 to 3 minutes.
Do not boil the cup for more than 3 minutes.
- Disinfect and sterilize using chemicals**
Use sterilizing agent for nursing supplies. For details, follow instructions of the sterilizing agent. Depending on the composition of the sterilizing agent, the silicone parts may turn white and the printed color of the product may fade. Do not soak more than 1 hour.
- Sterilizing using a microwave oven**
Use a sterilization tool for nursing supplies. For details, follow instructions for each tool.

Storage

- Keep the mug out of the reach of the children as the small parts may pose a choking hazard.

Before the children can drink water with the straw

For children who are not accustomed to using it at the beginning, please fill with drinks more than 150ml, it will be much easier to drink from the top of the straw when drinking.

Start training

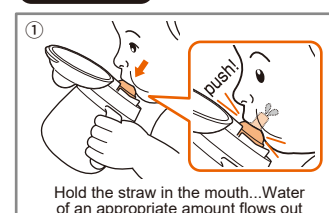

Hold the straw in the mouth...Water of an appropriate amount flows out

Learn drinking water with the straw

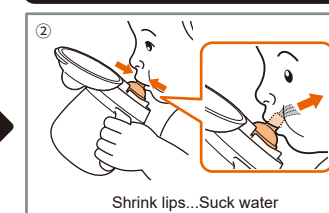

Shrink lips at the base of the straw and suck out a small amount of water.

After a child can proficiently drink water with the "first straw", use the "straw". The tip of the straw is expanded to form a shape that makes it easy for children to keep the straw in the mouth and drink water.

※ It is target. Let the child repeat continuously until the child can do it. The sequence ①→② is not necessarily followed. Guardians do not need to worry. Enjoy yourself while feeling the growth of children.

CAUTION

- Be sure to use the parts sold separately for the Lakumug series.
 - During use, if the straw or air vent's outside is pressed hard, the straw or air vent may sink. Therefore, do not press them.
 - Do not drop or bang on the mug. It may cause damage to the product.
 - Keep the product away from heat source.
 - Do not place the product in high temperature places such as a car in summer for a long time. Otherwise, deformation or damage of the product or drink overflow or leakage may occur.
 - Do not put the product in the refrigerator. Otherwise, deformation or damage may occur.
 - Stop using immediately if any crack, damage, deformation or missing parts are identified.
 - Do not use the product to store carbonated drinks. Otherwise, drink may overflow.
 - If you open the cap in a rush when using the first straw or straw, drink may flow out from straw tip. Only an adult is allowed to slowly open the cap.
- Cautions for silicon parts such as Drinking spout and Inner straw**
- You may notice white powder on the surface. This is a safety food additive.
 - Depending on the characteristics of the beverage, there may be residual flavor and color shift, but as long as it is thoroughly cleaned, there will be no hygiene problems.
 - Silicon parts are consumable parts. When any damage is found on the surface, stop using immediately and replace with a new one.
 - The silicon parts may not be elastic and become easily damaged for prolonged use, causing leakage. It is recommended to replace the parts in time.
- Cautions when microwave heating**
- Take extra care when microwave heating. Always stir heated food to ensure even heat distribution and test the temperature before serving.
 - Plastic parts may become deformed, melt or burn.
- Ensure you follow the instructions below.

Lakumug series

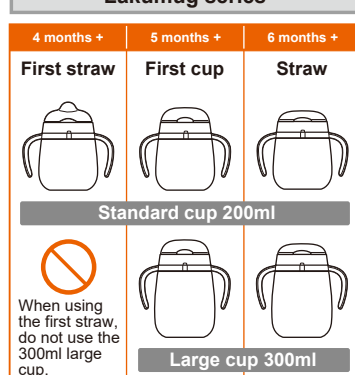

When using the first straw, do not use the 300ml large cup.

※ The age indicated is the estimated start time of training. The actual start time should be determined according to the growth situations of children. In addition, adults should help children before they can drink using the cup unaided.

First straw 4 months +

- Straw type**
Lakumug first straw is a straw type mug that can be used for training of drinking.
- To assist the child's smooth transition from nipples to straws, the drinking spout is designed with an enlarged base transitioning to the straw shape, so baby can easily hold it in their mouth like a nipple.
 - When baby holds the straw in their mouth, the base of the straw is pressed and water of an appropriate amount flows out from the tip of the straw. As baby drinks they are learning how to use the straw by holding it in their mouths, pushing and sucking.
- Parts sold separately**
- Cap adapter
 - Drinking spout
 - Inner straw

First cup 5 months +

- Cup type**
Lakumug first cup is a cup type mug that can be used for training of drinking.
- The slit can be opened to let the water flow out when the children keep the drinking spout in their mouths. Therefore, you can train drinking using the cup without worrying about spilling.
 - When children drink using the first cup, adults should help them because children cannot control the tilt angle. A tilt check window where the tilt angle can be easily viewed is adopted.
 - For the target tilt angle, see "First cup" (Pages 11 to 12).
- Parts sold separately**
- Cap adapter
 - Drinking spout

Straw 6 months +

- Straw type**
Lakumug straw is a mug used to drink water using a straw.
- The product adopts a unique valve structure and is leak-proof. When the cap is opened, you can prevent the straw from leaking through the manual air valve.
 - The drinking spout adopts the tip shape that makes it easy for children to hold in mouth.
 - The drinking spout is made of a soft material and can protect the mouths of children. (Biting hard may cause crack).
 - 1: No leakage does not cover the situations of misuse or aging.
- Parts sold separately**
- Cap adapter
 - Drinking spout
 - Inner straw

Straw

- The cup adopts a structure with a convex part. When the cap is opened a little, you will hear a click sound. When you use the product, slowly open the cap. To close the cap, press it downward until a click sound is heard, which means the cap is locked.
- How to assemble**
- As shown in the figure, install the straw and air vent by pushing them from inside of the adapter.
 - As shown in the figure, insert the inner straw all the way until it reaches its installation position.
 - After the inner straw is inserted, gently pull the straw to ensure that it cannot be pulled out.
 - Install the handle on the cup.
 - Close the cap and install the adapter on the cup. Screw up until the protruding part match with the protruding part of the handle.
- How to disassemble**
- As shown in the figure, remove the straw and air vent by pushing them from outside.
- How to close the cap**
- Directly close the cap. Do not touch the drinking spout of the straw.
- CAUTION**
- When drink flows out from the tip of the straw, see page 14.

When drink flows out from the tip of the straw

If you place the first straw and straw while the cap is opened, drink may flow out from the straw due to pressure difference caused by the temperature difference between the inside and outside of the cup. In this case, as shown in Figure B, hang the air vent on the protruding part of the adapter side to open the air valve to release pressure and prevent drink from flowing out from the straw.

※ If you overturn and carry the cup in the state shown in Figure B, drink may spill out. Before handing over the cup to children, be sure to restore the air vent to the normal state (as shown in Figure A).

※ As shown in the Figure C on the right, press the air vent with fingers to make it deform and temporarily release pressure.

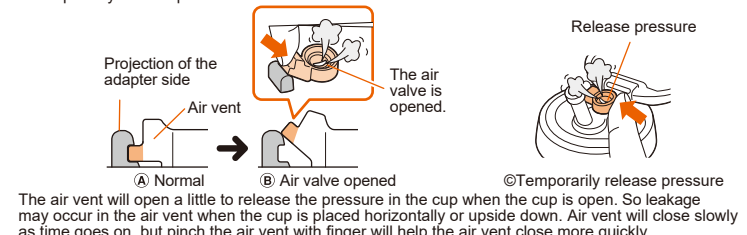

- CAUTION**
- Please do not keep, horizontally place or shake the cup with the cap open, drink may leak out from the tip of the straw and the air vent.
 - Drink may overflow when open the air vent.
 - Please close the cap for storage.