

Patto

Instruction manual

192286070-316

IMPORTANT – READ CAREFULLY AND KEEP FOR FUTURE REFERENCE.

Use of five-point safety harness

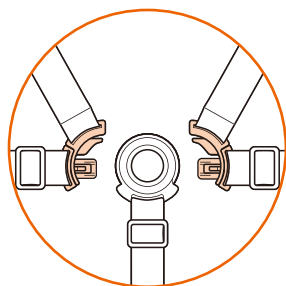

1. Buckle: When you hear a "click" sound, the safety harness is securely buckled.
2. Length adjustment of safety harness
Lengthen: Lengthen the adjustment belt in the direction a1, and then tighten it in the direction a2.
Shorten: Lengthen the adjustment belt in the direction b1, and then tighten it in the direction b2.

Note: For the safety of children, please make sure that the safety harness is securely buckled when using the stroller.

⚠ WARNING

1. Always use the restraint system.
2. Do not cross or adjusting it too tight the shoulder belts with each other when securing the shoulder to the insert plastic. Otherwise excessive pressure may be caused to child's neck.

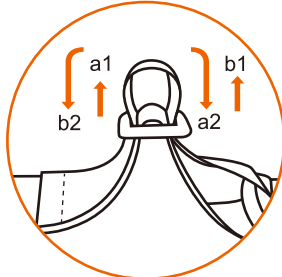
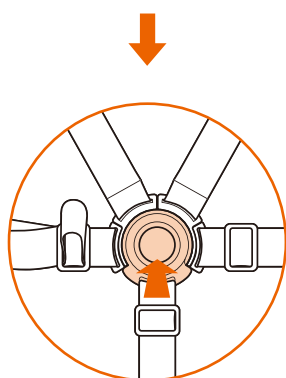

Instructions for installing the seat cushion with shoulder/ waist/ center strap cover

1. Insert the sleeping mat through the shoulder belt, waist belt, and crotch belt on the seat to install the sleeping mat.
2. Put on the shoulder belt covers and crotch belt cover in turn.

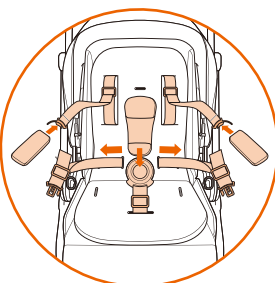
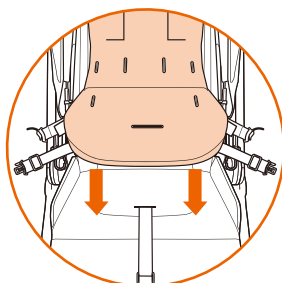

3. As show in the images, straps and belts can be adjusted according to your child's size .



Wheel assembly

For easy cleaning and storage, the rear wheels support the quick release function.

1. Press and hold the rear wheel quick release button to pull out the rear wheel.
2. When installing the rear wheel, insert the bearing inward and pull the wheel to ensure the installation is complete.

Note: Do not insert foreign objects into the axle holes because the objects may cause incorrect installation of the rear wheels.

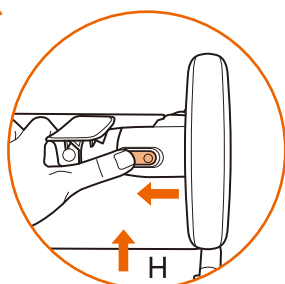
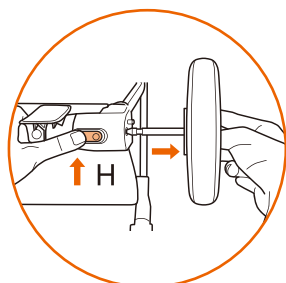

Backrest

Push the adjustment buckle behind the head upwards to adjust the backrest angle.

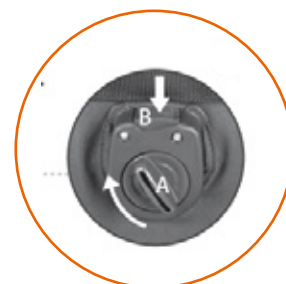

Front guard

Front guard: Adjust the slider with a protruding square button on the front guard plug to align with the square hole of the front guard socket on the stroller and insert it until you hear a "click" sound.

Note: 1. When installing the front guard, please aim the front guard button at the front guard seat to avoid incorrect assembly, and pay attention to the installation method to avoid pinching.



The stopper

⚠ WARNING

Always engage the stopper when you leave the stroller.

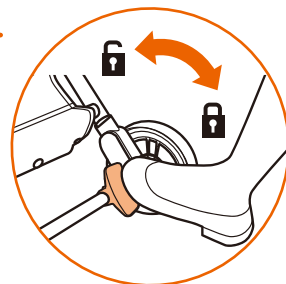

Foot support

Press the buttons on both sides of the arrow with both hands to adjust the foot support.



Basket

The basket's maximum load weight is 5 kg.

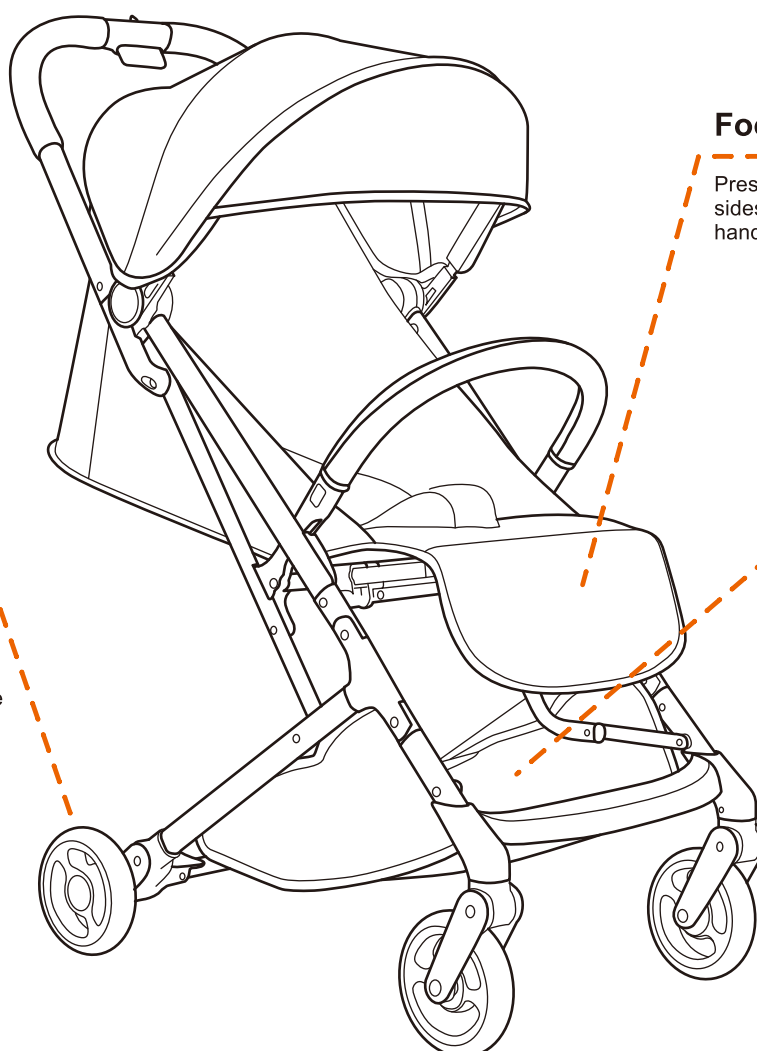
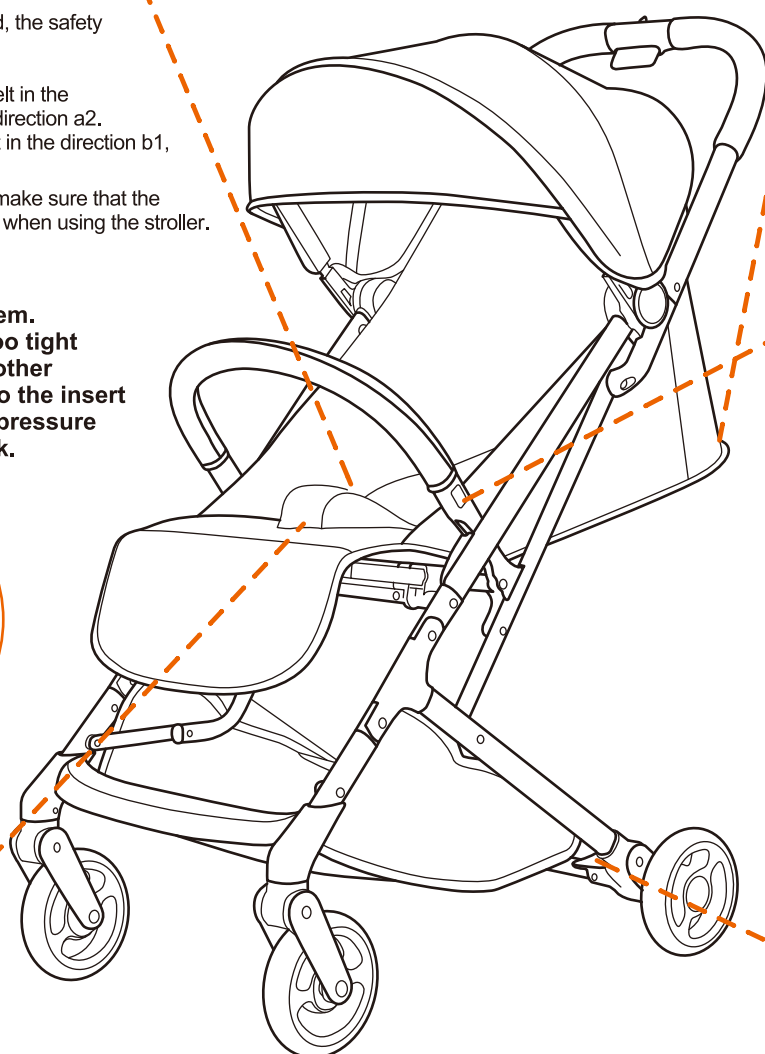
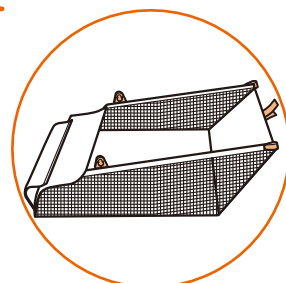

Unfolding the stroller

- 1. Lift the handle backward and upward to unfold the stroller. Shake the handle up and down to confirm that the stroller is fully unfolded and locked.
- 2. Pull the seat in the direction of the arrow and press the pedal adjustment button with both hands to adjust the pedal.
- 3. As show in figure, if it is not strong enough to open with one hand, you can hold the handle with both hands to ensure that the frame is opened and locked.

Note: When unfolding the stroller, please pay attention to the installation methods to avoid pinching.



Folding the Stroller

- 1. Go in steps reserve, adjust the backrest to the highest position and close ① the canopy;
- 2. Press and hold the second lock button with thumb and move it to the right, keeping the first action, press button B with 4 fingers at the same time, and then press stroller down.
- 3. After completed the steps, the folded stroller should able to stand up by itself.

Note: When folding the stroller, Please pay attention to the installation methods to avoid pinching.

Shoulder Strap for Travel

- Product can use with shoulder strap. It can use the shoulder strap on the shoulder and free up hands to take care children.
- After fold the stroller, attach the hooks of the strap on the stroller .④

⚠ WARNING

- Any wrappings such as coverings and cable ties should be removed or kept away from children.
- When unfolding / folding the stroller, it must be made clear that the infant's limbs are kept at a safe distance from the trolley. And the operator should not touch the folding mechanism such as the dotted coil to avoid pinching.
- When opening the stroller, please make sure locking and life the handle up to check that it is fully locked.
- Never allow the harness tightening strap to become caught in moving parts (e.g. automatic doors, escalators, etc.).
- when the stroller is in use, the portable shoulder strap cord should be removed and not kept in the sitting area, away from the child..



⚠ WARNING (Incorrect operation may cause serious injury or death)

The safety of the child may be seriously endangered if the instructions are not followed. You are personally responsible for the safety of your child.

- The stroller is suitable for children from newborn (1 month) up to 22kg (approximately 4 years old).
- Under EN 1888-2:2018+A1:2022 safety standard.
- Never leave the child unattended.
- The stroller is not allowed to carry two or more children or other items at the same time.
- Overloading, incorrect folding and the use of non-approved accessories may damage this stroller.
- Before use, make sure that the stroller stands upright and all mechanisms are fixed to ensure safety.
- To avoid injury ensure that the child is kept away when unfolding and folding this product.
- Do not let the child play with this product.
- Always use the restraint system to avoid any possible accident.
- The safety harness or restraint system must be correctly buckled and used.
- When adjusting any movable parts of the stroller, keep a safe distance between the child's limbs and the stroller.
- The child may slip into gaps near the sole of its feet, which may cause suffocation.
- Do not use the stroller on stairs.
- Do not place the stroller near fire, high temperature, pool, or electric source.
- Do not allow your child to stand up in the stroller. This can increase the risk of falling and may lead to serious injury.
- Do not leave the stroller on roads, ramps or any other dangerous places.
- Do not lift stroller while child is still inside.
- Do not move the stroller by holding the seat.
- Be sure to use all braking devices when parking the stroller.
- To prevent accidents, ensure that the stroller is kept away from any automatically closing doors (for example, doors of train or elevator).
- This product is designed to be used for walking only.
- This product is not suitable to be used for running or skating.
- Ensure that all the locking devices are engaged before use.
- To avoid the risk of suffocation, any coverings and binding straps must be removed, destroyed or kept away from the child.
- Excessive weight may cause a hazardous and unstable condition exist. (Maximum load:22kg. Basket maximum load:5kg).
- When adjusting the seat angle with a child seated in the stroller, please adjust the safety harness to a proper length. Do not adjust the seat angle while you are moving the stroller. Do not suddenly change the seat angle.
- If one gives excessive shock to the front wheels when getting over the step, stroller may fall down and cause damages. When stepping over, such as a curb, please slow down even a slight difference level, pull downward the handle and step on the foot-step, and make sure to pass the front wheels to get over the step.
- Lift front wheels and pay particular attention to gaps or ditch when crossing rail road to avoid the front wheels from accidentally getting to jammed and tipping over.
- Do not use in a reclined angle less than 150° for a child under 6 months old. when a child under 6 months old, please use of the most reclined position.
- Any loading attached to the handle affects the stability of the stroller, on the back of the backrest and/or on the sides of stroller will affect the stability of the stroller.
- Only replacement parts supplied or recommended by the manufacturer/ distributor shall be used. Only use original accessories and parts that have been approved by the manufacturer. Do not make any modifications to the product.
- The parking device shall be engaged when placing and removing the children or stop the stroller, in case of sudden brake or turning, and then the stroller may fall off.
- Do not place toys or things with straps attached around the infant riding around in a baby carriage.
- Check regularly that all screws, bolts and nuts are engaged tightly.
- In the event of damage or operation problems, stop using the stroller immediately and keep it out of reach of children.

Maintenance and Cleaning

- Never apply force on any mechanism or moving parts.
- To prevent mildew forming, do not store this product in a wet or humid environment.
- Avoid prolonged exposure of the product to rain or snow.
- Clean with a wet cloth. For stubborn stains, use a diluted mild detergent.
- After wipe off the dirt by detergent, use a cloth to wipe off the excess water and detergent.
- Dry in shade area after wipe off water.
- You may lubricate moving parts of the wheels if they are not smooth. Please do not apply excessive amount of lubricating oil to cause possible malfunction.
- If you notice any wear and tear on the stroller wheels that affects its usability or causes operational issues, please contact customer service immediately.

Hong Kong and South East Asia countries



For more information, you can scan this QR code.

Consumers from Hong Kong and South East Asia countries, please refer to below

Supplier: Combi Hong Kong Limited
Address: Units 1616-18, 16/F, Tower 1, Grand Century Place, 193 Prince Edward Road West, Mongkok, Kowloon, Hong Kong

Combi Corporation